

## **Self-Contained Unit** **Specifications:**

### Kitchen:

- High Quality Cabinets in white
- Soft close doors
- Granite composite sink with tap
- Electric Stove top
- Double Power point
- Hard Wearing Wood like Vinyl Floor
- LED Lighting

### Lounge/Bedrooms:

- Option of Luxurious Carpet or Hard Wearing Vinyl Floor
- Multiple Double Power points
- Opening Window/s
- LED Lighting

### Bathroom:

- Large 900x900, 1000x800 or 1200x 800 Shower
- Extractor fan
- Mirror
- Wall Vanity
- Modern Standard Toilet
- Hard Wearing Wood like Vinyl Floor

### Structure:

- Electrical WOF
- Built on skids for portability
- Ranch Slider
- Walls and Roof are fully Insulated
- Insulated Floor
- LED Lighting Throughout
- Certified Gas with Hot Water Califont, 2 x Full 18kg Bottles, Automatic Changeover and Gas Fitting

*Our Self-Contained Units come with a roomy Bathroom and full sized shower.*

*The rest of these units are customizable in regards to Floor Plan, Kitchen Layout, Ranch Slider/Window positions and Vinyl/Carpeted areas.*

*The choice is yours to create your perfect Self-Contained Unit.*

## **Prices for Self-Contained Unit (All Prices Inc. GST):**

Date: 2021

### **6m Self-Contained Unit:**

**\$69,990** – Standard - 2.4m Wide

**\$79,990** – Standard - 3.0m Wide

**\$99,990** – Luxury - 2.4m Wide

**\$102,990** – Luxury - 3.0m Wide

Add **\$9,990** for Warranted and Registered, Braked, Tandem Axle Trailer

### **7.2m Self-Contained Unit:**

**\$79,990** – Standard - 2.4m Wide

**\$84,990** – Standard - 3.0m Wide

**\$104,990** – Luxury - 2.4m Wide

**\$107,990** – Luxury - 3.0m Wide

Add **\$9,990** for Warranted and Registered, Braked, Tandem Axle Trailer

### **7.8m Self-Contained Unit:**

**\$87,990** – Standard - 2.4m Wide

**\$89,990** – Standard - 3.0m Wide

**\$109,990** – Luxury - 2.4m Wide

**\$113,990** – Luxury - 3.0m Wide

Add **\$9,990** for Warranted and Registered, Braked, Triple Axle Trailer

### **8.4m Self-Contained Unit:**

**\$97,990** – Standard - 2.4m Wide

**\$99,990** – Standard - 3.0m Wide

**\$114,990** – Luxury - 2.4m Wide

**\$118,990** – Luxury - 3.0m Wide

Add **\$9,990** for Warranted and Registered, Braked, Triple Axle Trailer

### **9.6m Self-Contained Unit:**

**\$101,990** – Standard - 2.4m Wide

**\$104,990** – Standard - 3.0m Wide

**\$122,990** – Luxury - 2.4m Wide

**\$126,990** – Luxury - 3.0m Wide

Add **\$9,990** for Warranted and Registered, Braked, Triple Axle Trailer

### **10.8m Self-Contained Unit:**

**\$107,990** – Standard - 2.4m Wide

**\$109,990** – Standard - 3.0m Wide

**\$127,990** – Luxury - 2.4m Wide

**\$129,990** – Luxury - 3.0m Wide

Add **\$9,990** for Warranted and Registered, Braked, Triple Axle Trailer

*All our units are designed  
and built to perfection,  
incorporating quality, style,  
looks and comfort.*

*The tasteful and modern  
interior has timeless  
neutral colours.*

*“The Best Quality and  
Nicest Looking Tiny Homes  
and Cabins you will find”*

## Optional Extras:

- Transport to your site = \$TBC
- 
- **Service Options (Power, Fresh Water, Waste Water, Sewage):**
  - Residential / Plug in
    - Modern Standard Toilet = Included
    - Caravan Plug (for Power) = Included
    - Water Hose (for Fresh Water) = Included
    - Macerating Pump (for Toilet, Kitchen & Shower Waste) = \$1,250
  - 
  - Rural / Off Grid
  - - Waterless Dehydrating Composting Toilet = \$2,500
    - Grey Water Filtration System = \$1,950
    - Water Tank 5000lt (you to organise with your local supplier) = \$1,000 Approx.
    - Water Pump with Accumulator Tank = \$650
    - Solar Setup (Pricing depends on the size you need):
      - 2.4Kw = \$9,990
      - 4.8Kw = \$13,990
      - 7.2Kw = \$16,990

## What does the Luxury have that the Standard does not:

- Higher Ceiling Height
- More Windows
- Exterior Cedar Feature Wall
- Exterior Cedar barge board
- Interior Feature Wall
- Bigger Kitchen
- Gas Stove Top
- Premium Kitchen cabinetry with the included option of an Island Bench
- Overhead Kitchen Cabinets
- Range Hood
- Splash back
- Superior Tap ware
- Premium Bathroom
- More Lighting
- Coloured Feature Lights
- The included option of having a simple sleeping loft
- The included option to design your floor layout to your preferences
- Separate Bedrooms
- Harder wearing and better quality flooring
- The included option of carpet
- An all-round more Luxury and Beautiful look and feel
- The option of built in Couches, Beds, Wardrobes etc. (extra cost)

### You can also choose the following items:

Floor Plan and Layout, Exterior Colour, Roof and Flashing Colour, Interior Paint Colour, Interior Trim Colour, Flooring, Tapware, Benchtops, Kitchen Cabinet Style and Layout to a certain extent.

**To Note:**

- Initial deposit will secure your place in line for the next build slot. However, if you would like - we can slot your build in alongside other builds in order to get started earlier (this would mean that your build time is longer than stated below – but you should get your unit quicker). Priority of builds is always given to first in first served basis.
- The design process will be completed in the time between the initial deposit and the start of the build.
- Estimated physical Build time for a Unit is 12-14 weeks from the build start date as long as the design and appropriate deposits have been completed.
- All connections to the Unit are the Owners responsibility – this includes Waste Water Plumbing, Fresh Water Plumbing, Electrical (Caravan Cable supplied), Internet, TV aerial/Sky Dish etc.
- If you are purchasing the Solar System, then this will be Commissioned and Connected up on site by the seller, – However the Solar Panels are to be placed and secured by the purchaser. This is to be done on suitable supports supplied by the purchaser in a North facing position.
- The Client agrees and understands that the unit does not come with a COC on the building (all electrical and gas is certified and compliant).
- The Client understands and takes responsibility as to where Tiny Houses/Caravans sit with regards to their local Council.
- Delivery Costs and Transport Insurance for the Tiny House is to be paid for by the purchaser.

**Payment Structure:**

- Initial deposit of 10% due on signing of contract to secure build slot.
- Second deposit of 30% due 1 month before build start date so supplies can be ordered.
- Third deposit of 30% due once windows, cladding and roof is complete.
- *(If any other extra options are required including Solar, Composting Toilet, Waste Water etc. then a Fifth Deposit to cover these would be due. Timing and amount is case by case depending on setup)*
- Balance due upon client being satisfied of the completion of their Tiny House. Once balance is cleared, ownership papers are signed over to the client and delivery takes place.

## Floor Plans:

Below are some example Floor Plans. You are welcome to use ours or customise your own Floor Plan to suit your own preferences. (There is **NO** extra charge for having your own customised and personalised Floor Plan).

### 10.8m x 3m Floor Plans:

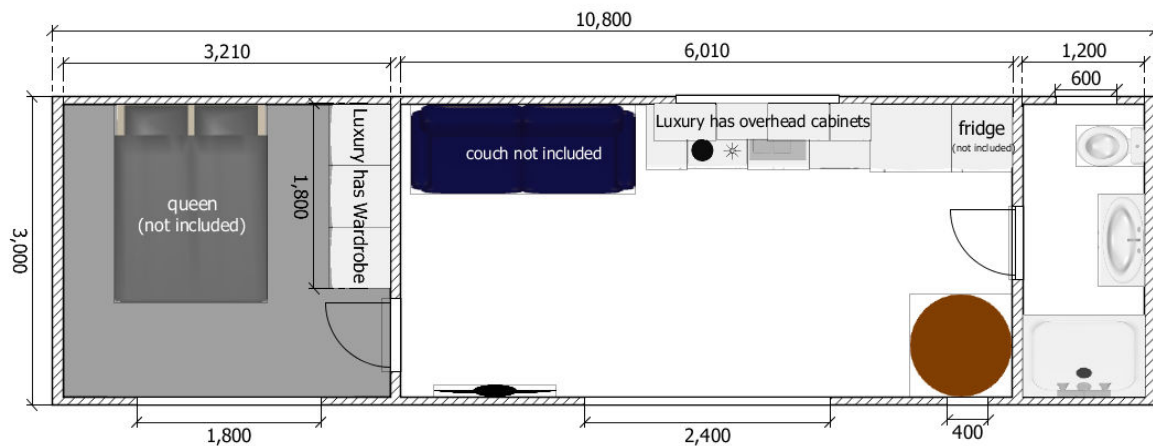
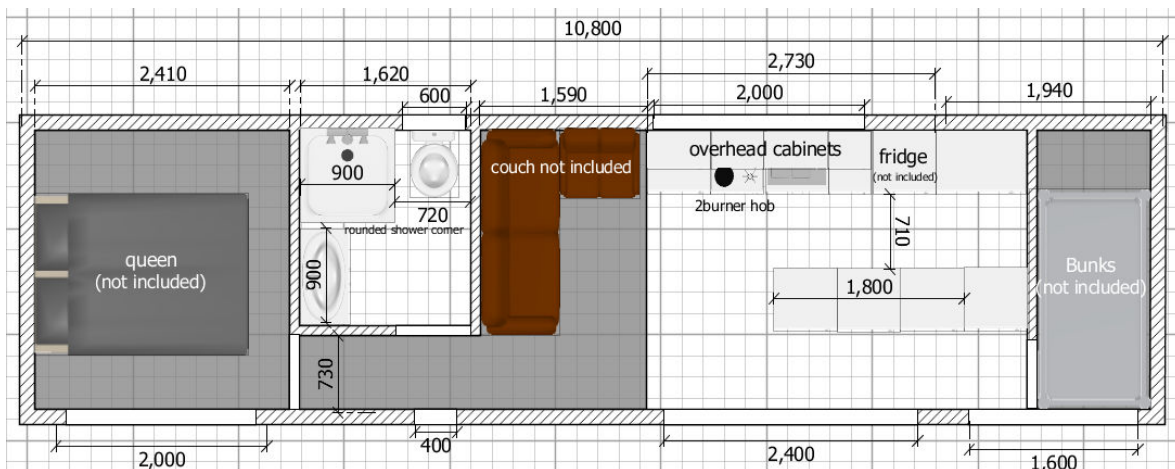
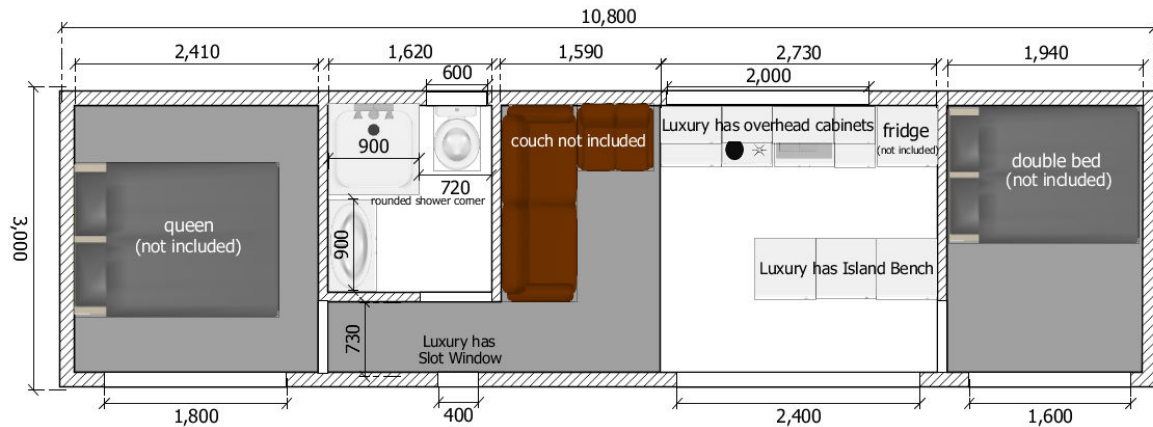

## 9.6m x 3m Floor Plans:

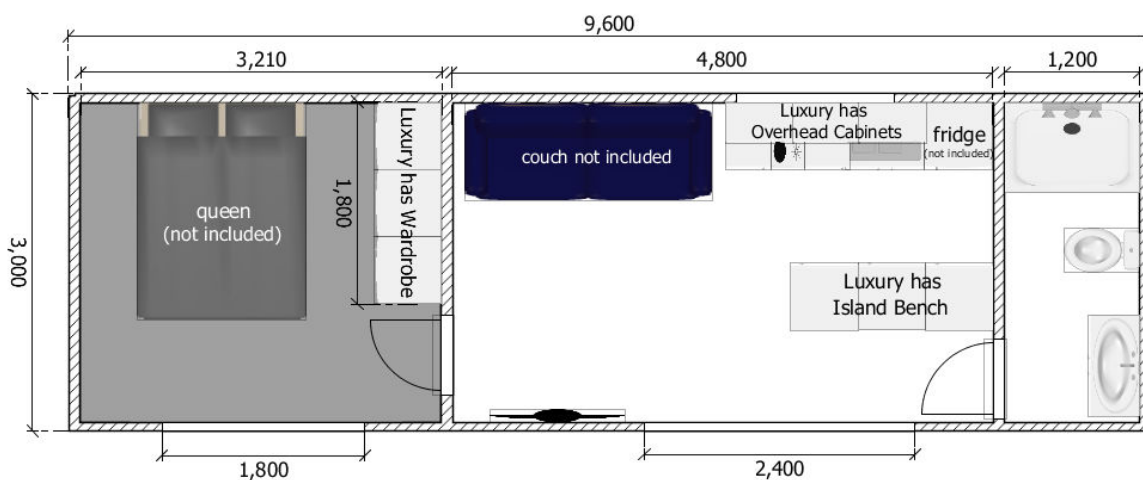
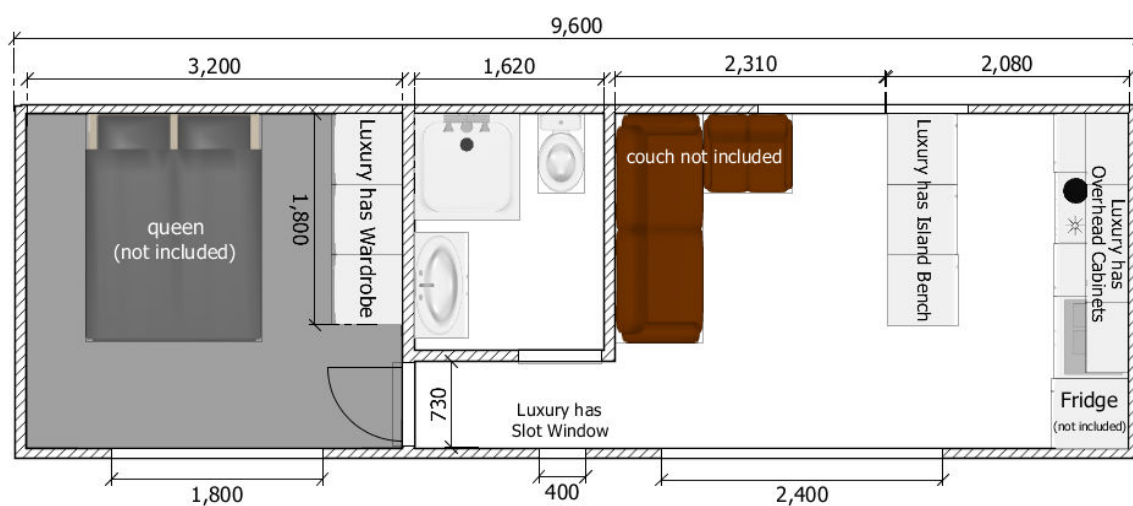
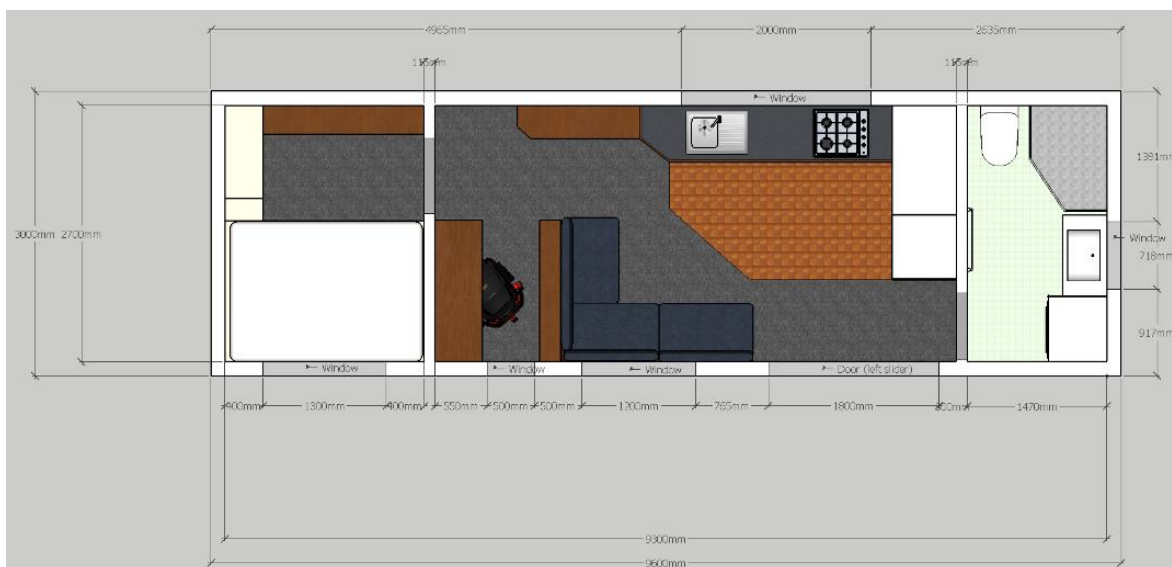

## 8.4m x 2.4m Floor Plans:

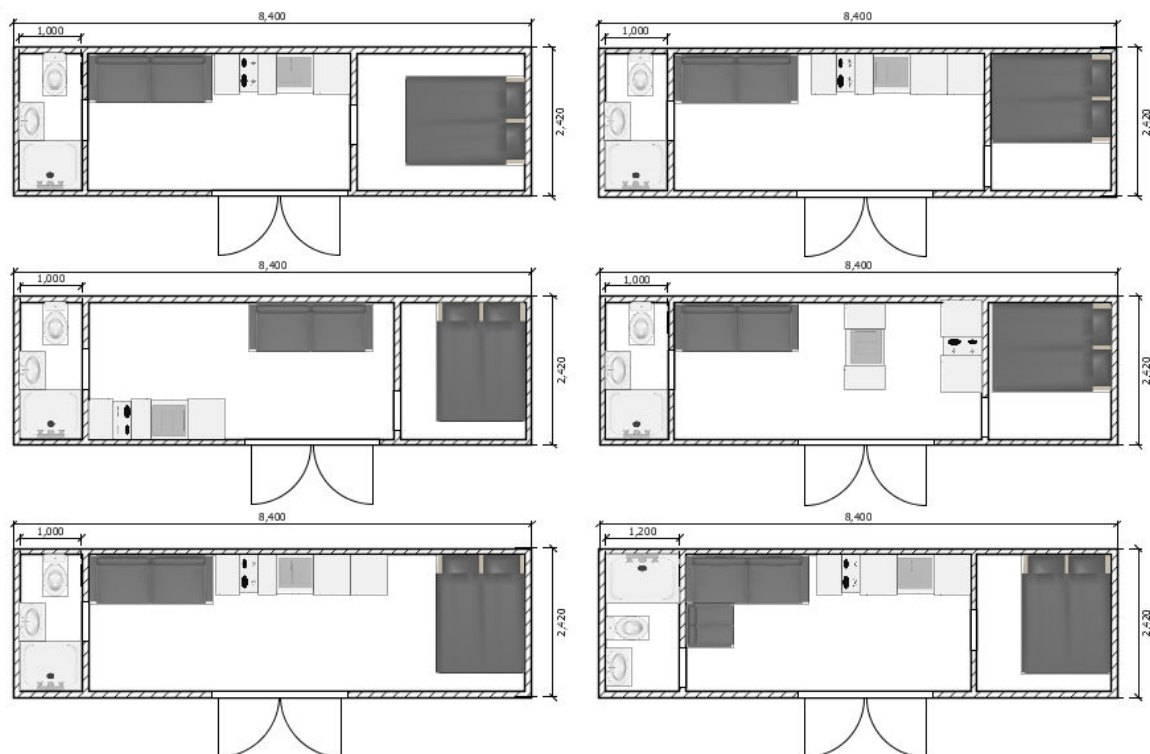



## **7.8m x 2.4m Floor Plans:**

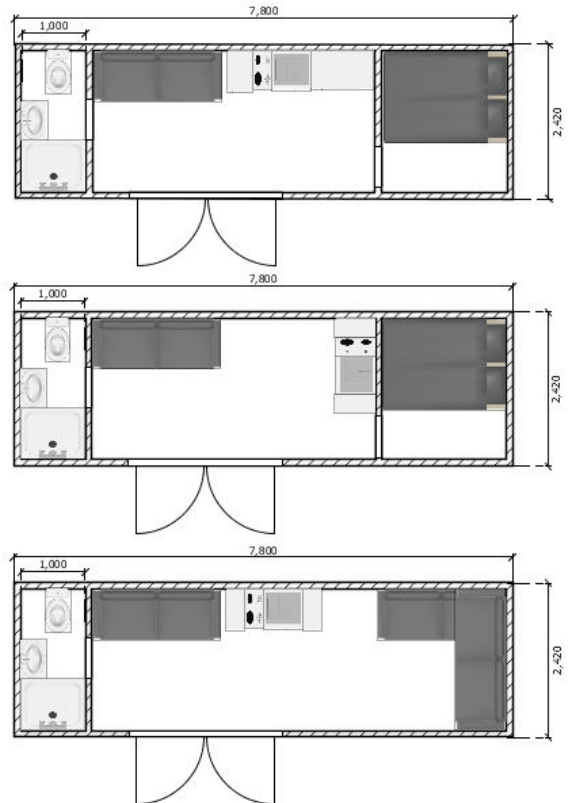
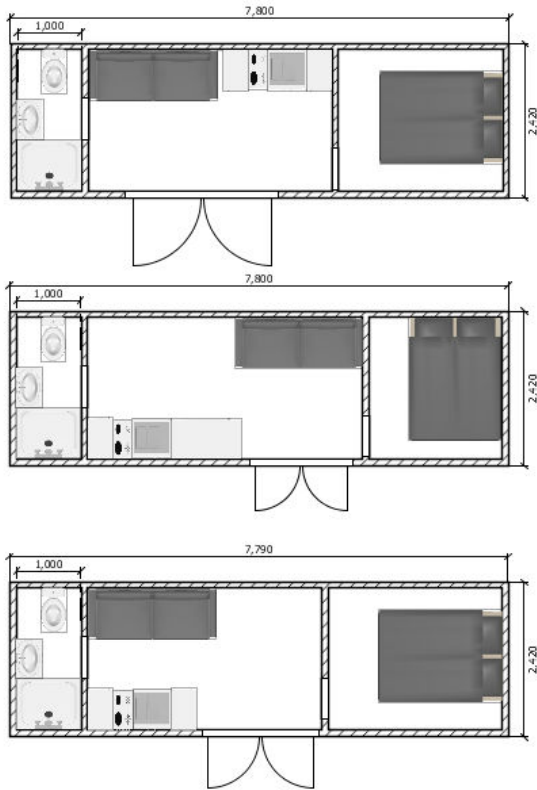



## 7.2m x 2.4m Floor Plans:

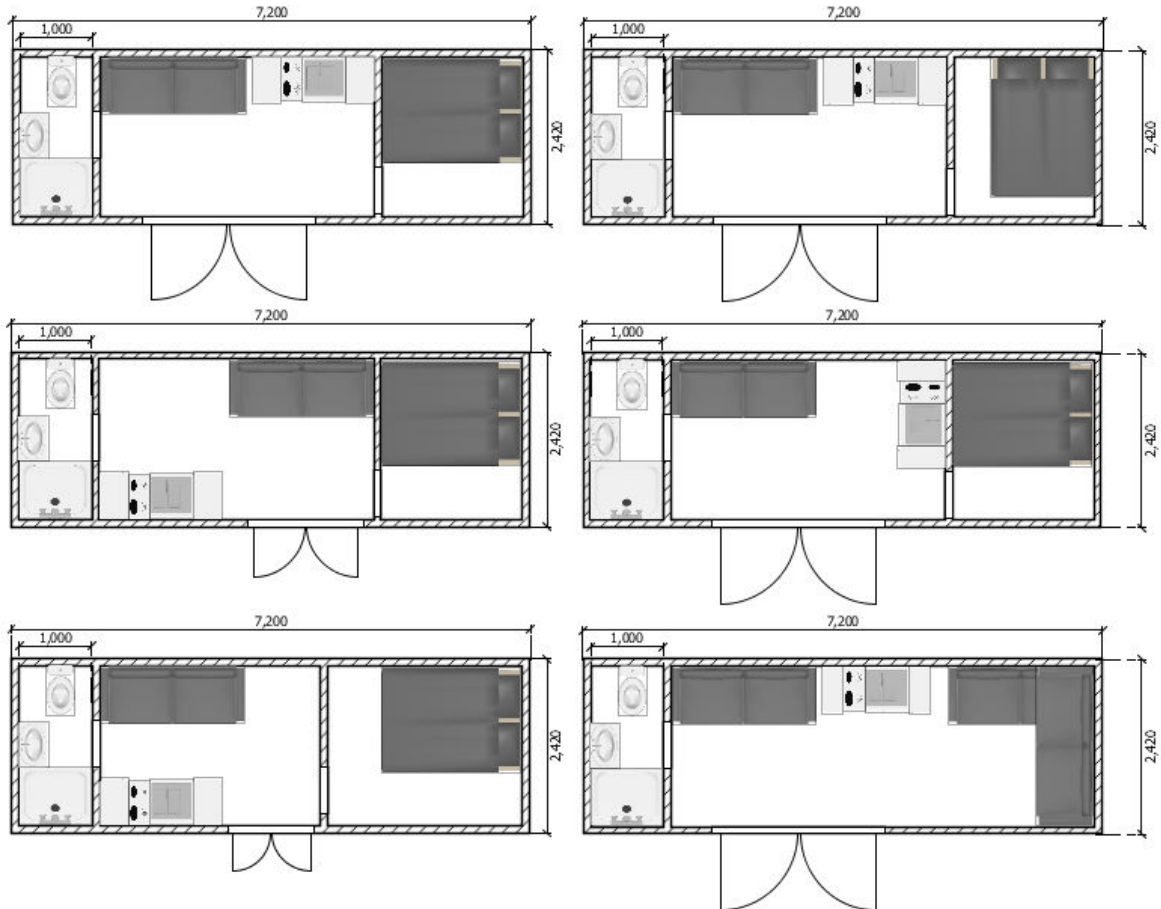

## 6m x 2.4m Floor Plans:

