

Self-Contained Unit **Specifications:**

Kitchen:

- High Quality Cabinets in white
- Soft close doors
- Granite composite sink with tap
- Electric Stove top
- Double Power point
- Hard Wearing Wood like Vinyl Floor
- LED Lighting

Lounge/Bedrooms:

- Option of Luxurious Carpet or Hard Wearing Vinyl Floor
- Multiple Double Power points
- Opening Window/s
- LED Lighting

Bathroom:

- Large 900x900, 1000x800 or 1200x 800 Shower
- Extractor fan
- Mirror
- Wall Vanity
- Modern Standard Toilet
- Hard Wearing Wood like Vinyl Floor

Structure:

- Electrical WOF
- Built on skids for portability
- Ranch Slider
- Walls and Roof are fully Insulated
- Insulated Floor
- LED Lighting Throughout
- Certified Gas with Hot Water Califont, 2 x Full 18kg Bottles, Automatic Changeover and Gas Fitting

Our Self-Contained Units come with a roomy Bathroom and full sized shower.

The rest of these units are customizable in regards to Floor Plan, Kitchen Layout, Ranch Slider/Window positions and Vinyl/Carpeted areas.

The choice is yours to create your perfect Self-Contained Unit.

Prices for Self-Contained Unit (All Prices Inc. GST):

Date: 2021

6m Self-Contained Unit:

\$94,990 – Standard - 2.4m Wide

\$97,990 – Standard - 3.0m Wide

\$104,990 – Luxury - 2.4m Wide

\$107,990 – Luxury - 3.0m Wide

Add **\$9,990** for Warranted and Registered, Braked, Tandem Axle Trailer

7.2m Self-Contained Unit:

\$99,990 – Standard - 2.4m Wide

\$102,990 – Standard - 3.0m Wide

\$109,990 – Luxury - 2.4m Wide

\$112,990 – Luxury - 3.0m Wide

Add **\$9,990** for Warranted and Registered, Braked, Tandem Axle Trailer

7.8m Self-Contained Unit:

\$104,990 – Standard - 2.4m Wide

\$108,990 – Standard - 3.0m Wide

\$114,990 – Luxury - 2.4m Wide

\$118,990 – Luxury - 3.0m Wide

Add **\$9,990** for Warranted and Registered, Braked, Triple Axle Trailer

8.4m Self-Contained Unit:

\$109,990 – Standard - 2.4m Wide

\$113,990 – Standard - 3.0m Wide

\$119,990 – Luxury - 2.4m Wide

\$123,990 – Luxury - 3.0m Wide

Add **\$9,990** for Warranted and Registered, Braked, Triple Axle Trailer

9.6m Self-Contained Unit:

\$117,990 – Standard - 2.4m Wide

\$121,990 – Standard - 3.0m Wide

\$127,990 – Luxury - 2.4m Wide

\$131,990 – Luxury - 3.0m Wide

Add **\$9,990** for Warranted and Registered, Braked, Triple Axle Trailer

10.8m Self-Contained Unit:

\$122,990 – Standard - 2.4m Wide

\$124,990 – Standard - 3.0m Wide

\$132,990 – Luxury - 2.4m Wide

\$134,990 – Luxury - 3.0m Wide

Add **\$9,990** for Warranted and Registered, Braked, Triple Axle Trailer

*All our units are designed
and built to perfection,
incorporating quality, style,
looks and comfort.*

*The tasteful and modern
interior has timeless
neutral colours.*

*“The Best Quality and
Nicest Looking Tiny Homes
and Cabins you will find”*

Optional Extras:

- Transport to your site = \$TBC
- Transport Insurance = \$TBC
- **Service Options (Power, Fresh Water, Waste Water, Sewage):**
 - Residential / Plug in
 - Modern Standard Toilet = Included
 - Caravan Plug (for Power) = Included
 - Water Hose (for Fresh Water) = Included
 - Macerating Pump (for Toilet, Kitchen & Shower Waste) = \$1,250
 - Rural / Off Grid
 - Waterless Dehydrating Composting Toilet = \$2,800
 - Grey Water Filtration System = \$1,950
 - Water Tank 5000lt (you to organise with your local supplier) = \$1,000 Approx.
 - Water Pump with Accumulator Tank = \$650
 - Solar Setup (Pricing depends on the size you need):
 - 2.4Kw = \$9,990
 - 4.8Kw = \$13,990
 - 7.2Kw = \$16,990

What does the Luxury have that the Standard does not:

- Higher Ceiling Height
- More Windows
- Exterior Cedar Feature Wall
- Exterior Cedar barge board
- Interior Feature Wall
- Bigger Kitchen
- Gas Stove Top
- Premium Kitchen cabinetry with the included option of an Island Bench
- Overhead Kitchen Cabinets
- Range Hood
- Splash back
- Superior Tap ware
- Premium Bathroom
- More Lighting
- Coloured Feature Lights
- The included option of having a simple sleeping loft
- The included option to design your floor layout to your preferences
- Separate Bedrooms
- Harder wearing and better quality flooring
- The included option of carpet
- An all-round more Luxury and Beautiful look and feel
- The option of built in Couches, Beds, Wardrobes etc. (extra cost)

You can also choose the following items:

Floor Plan and Layout, Exterior Colour, Roof and Flashing Colour, Interior Paint Colour, Interior Trim Colour, Flooring, Tapware, Benchtops, Kitchen Cabinet Style and Layout to a certain extent.

To Note:

- Initial deposit will secure your place in line for the next build slot. However, if you would like - we can slot your build in alongside other builds in order to get started earlier (this would mean that your build time is longer than stated below – but you should get your unit quicker). Priority of builds is always given to first in first served basis.
- The design process will be completed in the time between the initial deposit and the start of the build.
- Estimated physical Build time for a Unit is 12-14 weeks from the build start date as long as the design and appropriate deposits have been completed.
- All connections to the Unit are the Owners responsibility – this includes Waste Water Plumbing, Fresh Water Plumbing, Electrical (Caravan Cable supplied), Internet, TV aerial/Sky Dish etc.
- If you are purchasing the Solar System, then this will be Commissioned and Connected up on site by the seller, – However the Solar Panels are to be placed and secured by the purchaser. This is to be done on suitable supports supplied by the purchaser in a North facing position.
- The Client agrees and understands that the unit does not come with a COC on the building (all electrical and gas is certified and compliant).
- The Client understands and takes responsibility as to where Tiny Houses/Caravans sit with regards to their local Council.
- Delivery Costs and Transport Insurance for the Tiny House is to be paid for by the purchaser.

Payment Structure:

- Initial deposit of 10% due on signing of contract to secure build slot.
- Second deposit of 30% due 1 month before build start date so supplies can be ordered.
- Third deposit of 30% due once windows, cladding and roof is complete.
- *(If any other extra options are required including Solar, Composting Toilet, Waste Water etc. then a Fifth Deposit to cover these would be due. Timing and amount is case by case depending on setup)*
- Balance due upon client being satisfied of the completion of their Tiny House. Once balance is cleared, ownership papers are signed over to the client and delivery takes place.

Floor Plans:

Below are some example Floor Plans. You are welcome to use ours or customise your own Floor Plan to suit your own preferences. (There is **NO** extra charge for having your own customised and personalised Floor Plan).

10.8m x 3m Floor Plans:

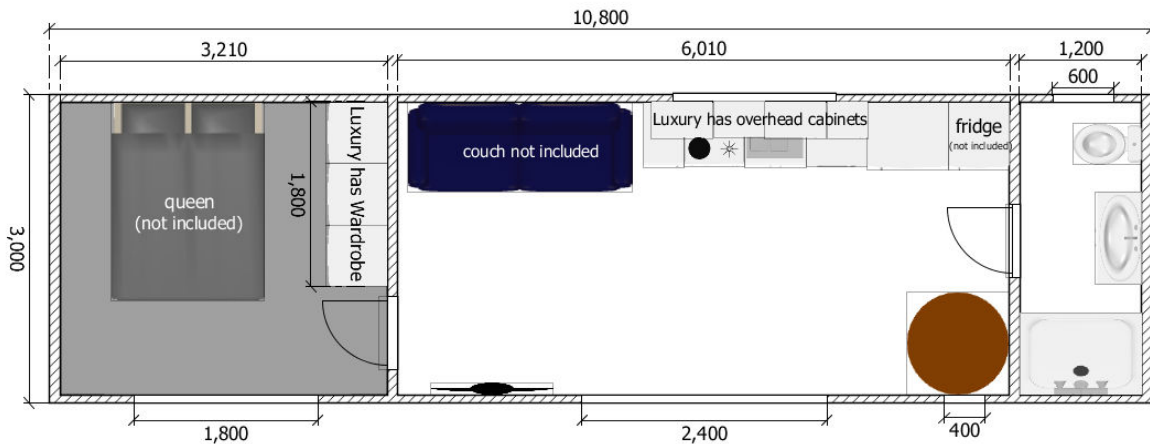
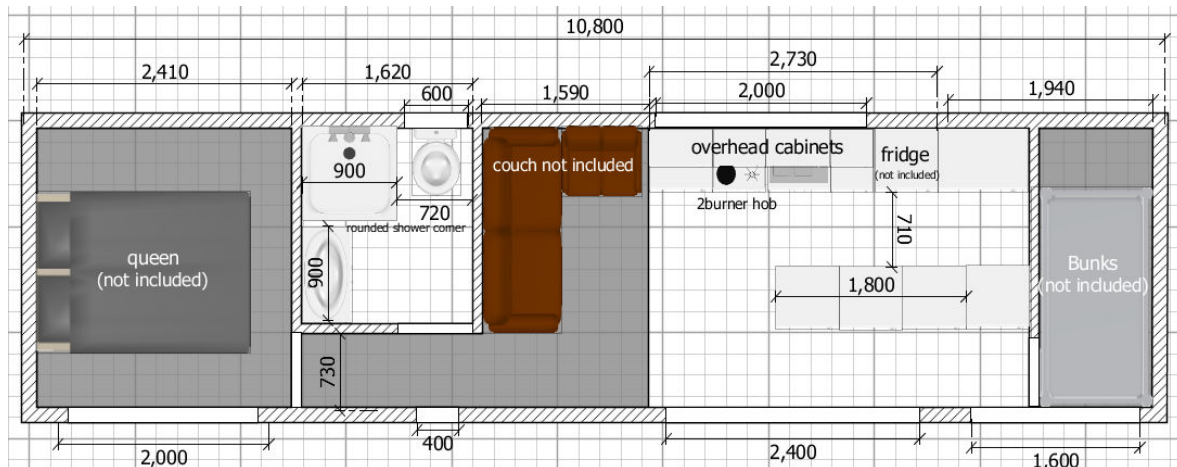
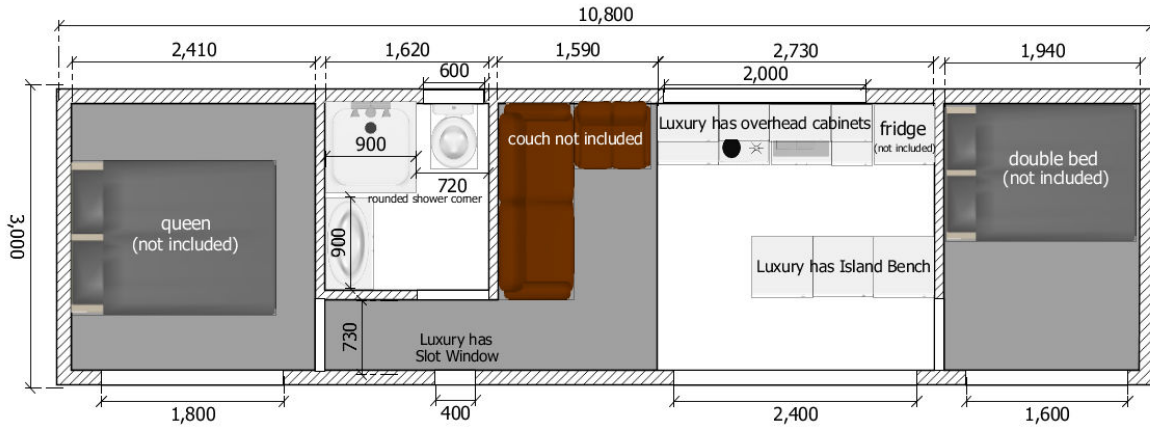

9.6m x 3m Floor Plans:

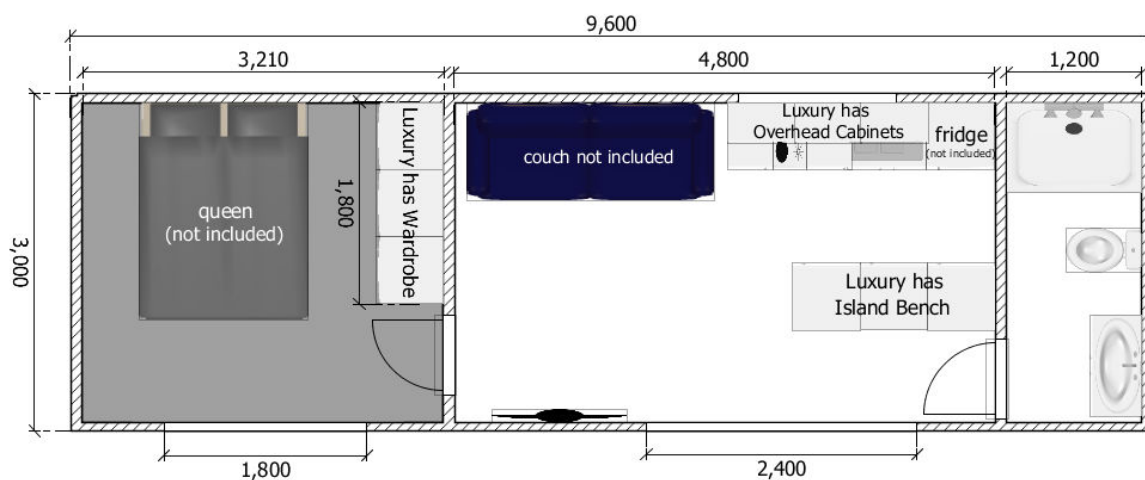
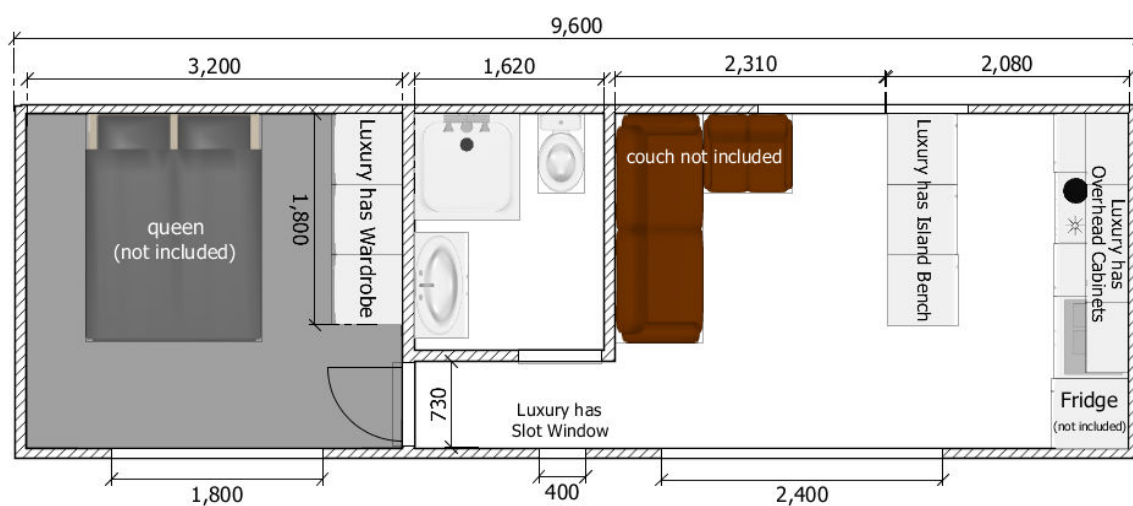
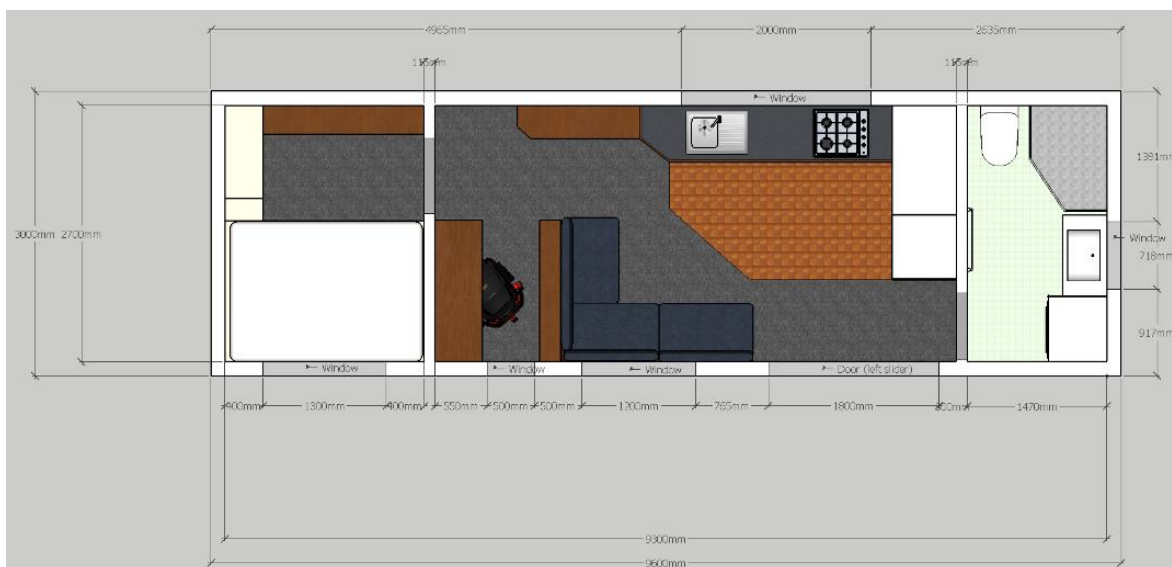

8.4m x 2.4m Floor Plans:

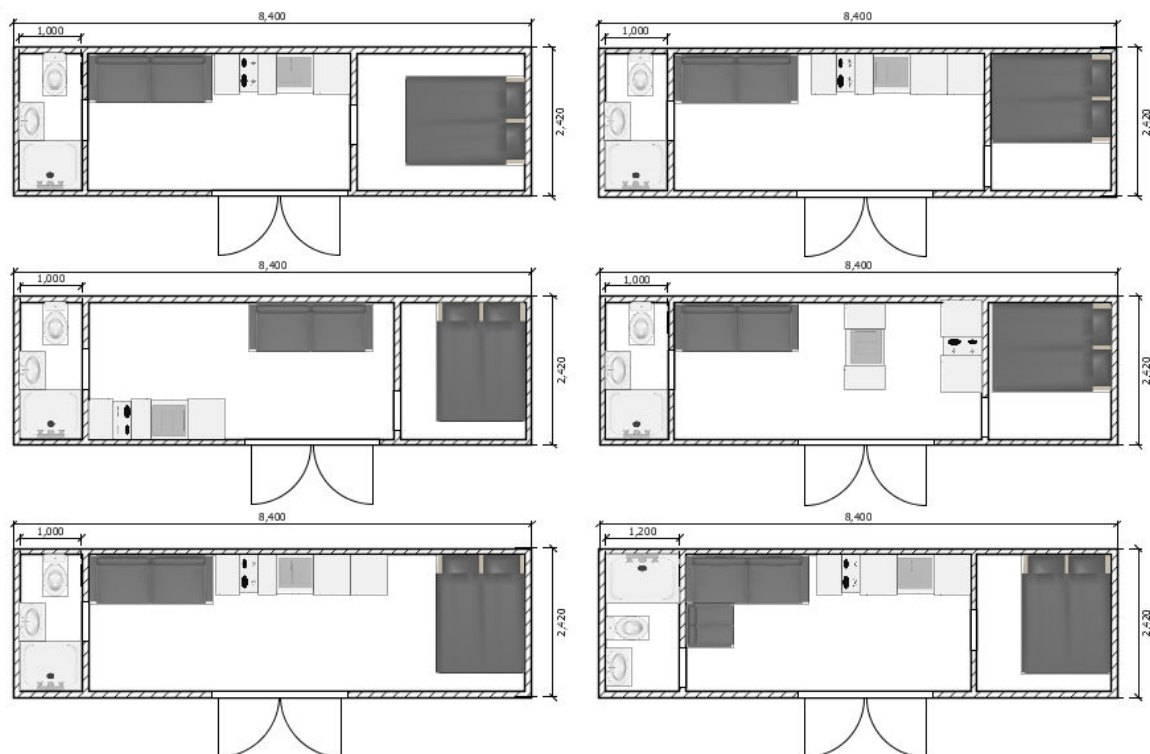

7.8m x 2.4m Floor Plans:

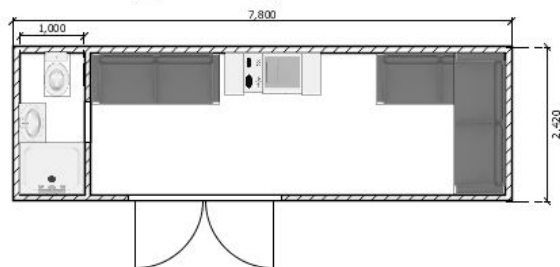
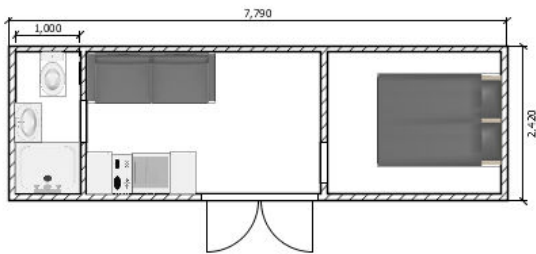
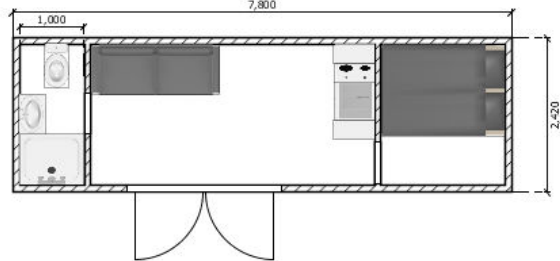
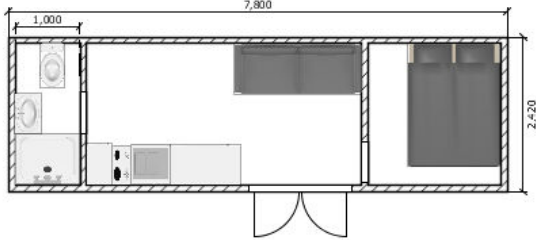
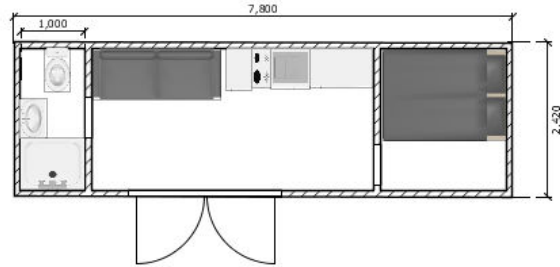
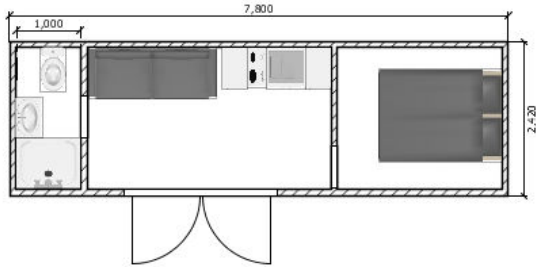

7.2m x 2.4m Floor Plans:

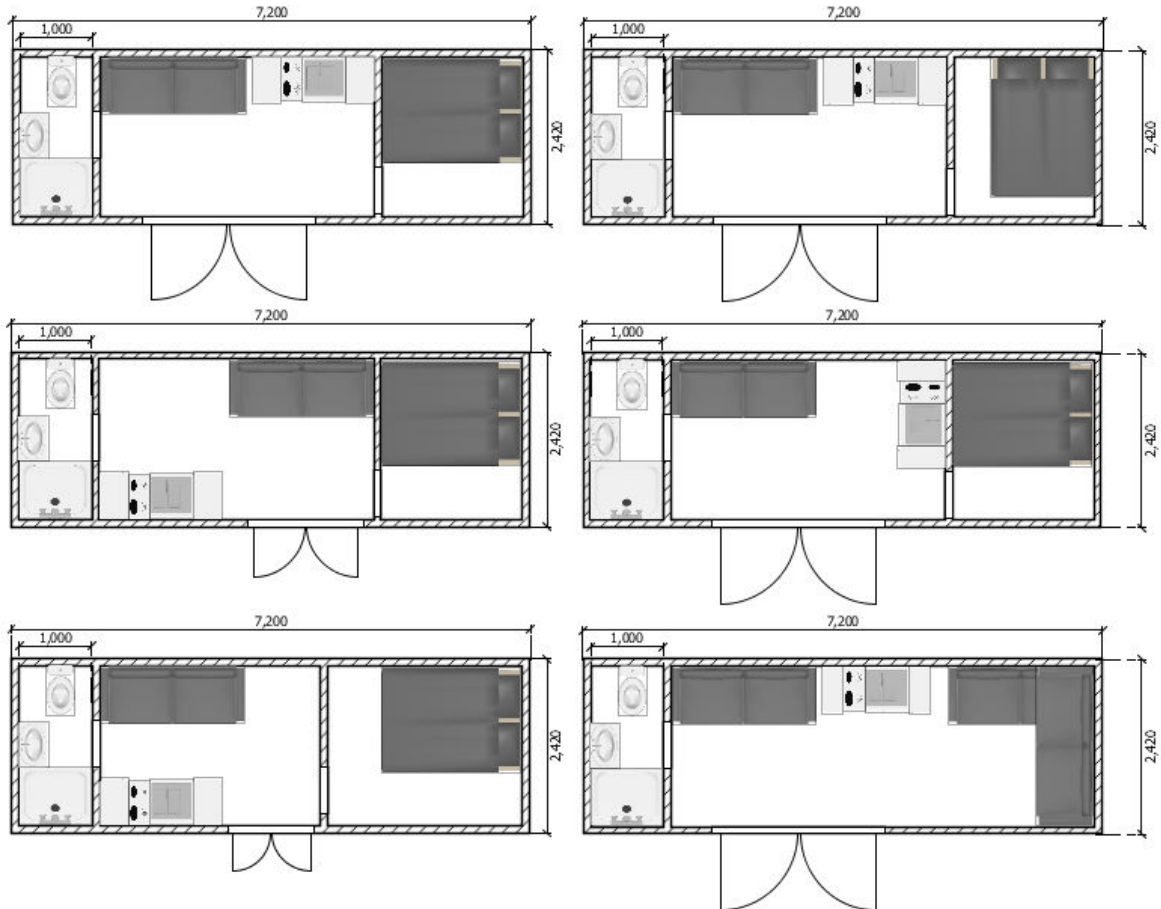

6m x 2.4m Floor Plans:

